

PROPOSED

PORT BAY BARRIER BAR

REHABILITATION AND PIER CONSTRUCTION

TOWNS OF HURON AND WOLCOTT

WAYNE COUNTY, NEW YORK

PROJECT CONTACTS

CIVIL ENGINEER

BERGMANN ASSOCIATES
280 EAST BROAD STREET, SUITE 200
ROCHESTER, NY
TIPHAIN KETCH, PE, CFM
585.498.7762

CONSULTING ENGINEER

JM DAVIDSON
525 WHEATFIELD STREET, SUITE 20
WHEATFIELD, NY
KRISTA GREER, PE, CFM
716.453.1646

CLIENT

WAYNE COUNTY SOIL & WATER CONSERVATION DISTRICT
7312 ROUTE 31
LYONS, NY
LINDSEY M. GERSTENSLAGER, MSED
315.946.7200

JURISDICTIONAL CONTACTS AND STAKEHOLDERS

PLANNING AND ZONING

CITY/TOWNSHIP NAME
1234 ANYTOWN DR
ANYTOWN, NY XXXXX
CONTACT NAME
CONTACT NUMBER

PORT BAY IMPROVEMENT ASSOCIATION

JURISDICTIONAL NAME
1234 ANYTOWN DR
ANYTOWN, NY XXXXX
CONTACT NAME
CONTACT NUMBER

STORM WATER AND SOIL EROSION AND SEDIMENTATION

JURISDICTIONAL NAME
1234 ANYTOWN DR
ANYTOWN, NY XXXXX
CONTACT NAME
CONTACT NUMBER

ROADS & ENTRANCE

JURISDICTIONAL NAME
1234 ANYTOWN DR
ANYTOWN, NY XXXXX
CONTACT NAME
CONTACT NUMBER

ELECTRIC

JURISDICTIONAL NAME
1234 ANYTOWN DR
ANYTOWN, NY XXXXX
CONTACT NAME
CONTACT NUMBER

GAS

JURISDICTIONAL NAME
1234 ANYTOWN DR
ANYTOWN, NY XXXXX
CONTACT NAME
CONTACT NUMBER

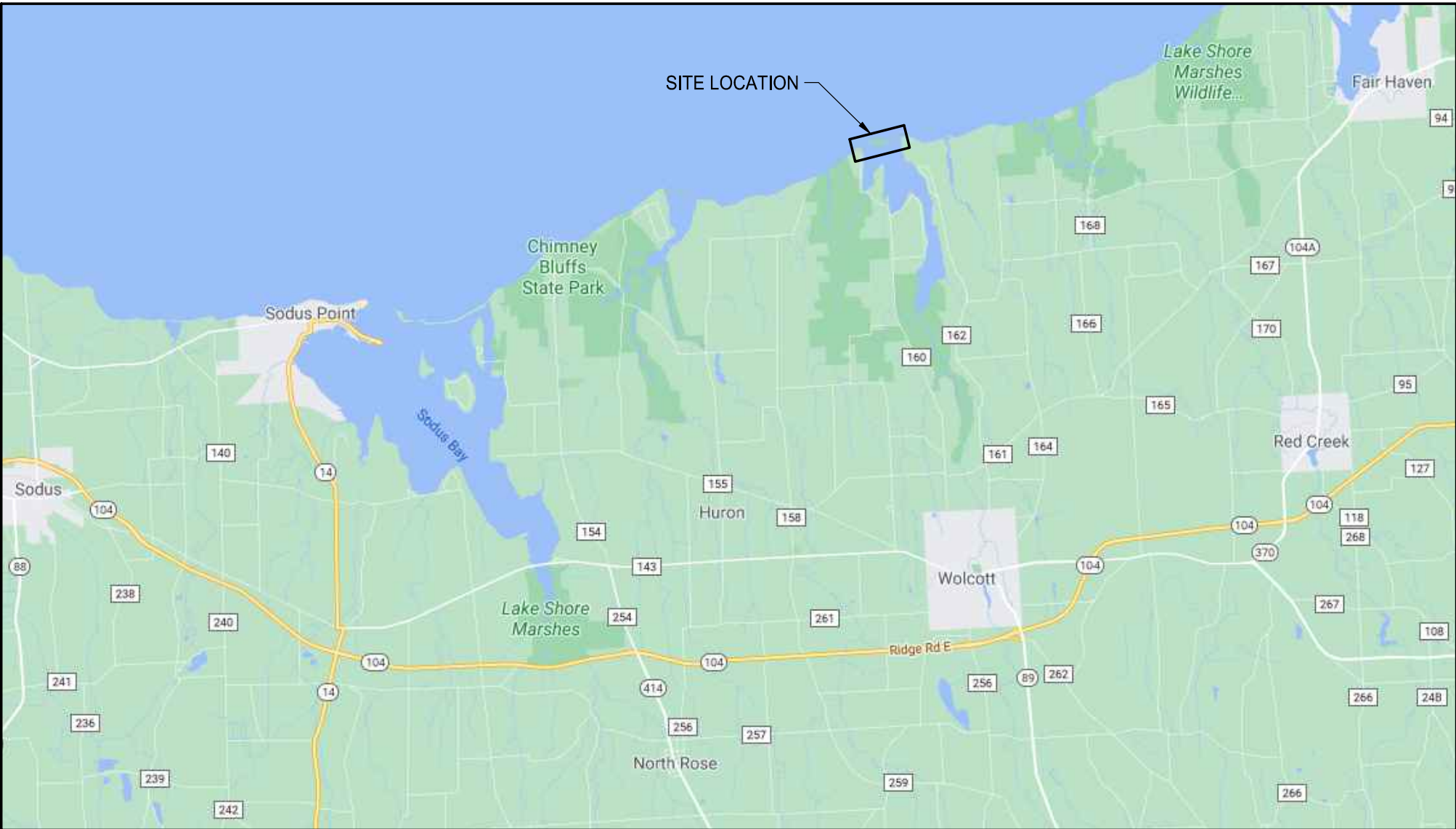

SITE LOCATION MAP
NOT TO SCALE

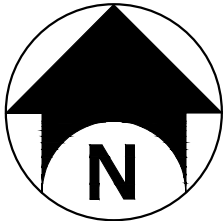

DRAWING INDEX

DRAWING NO.	DRAWING TITLE	SHEET NO.
-------------	---------------	-----------

PORT BAY
BARRIER BAR

SHORELINE REHABILITATION
AND PIER REPLACEMENT



Wayne County Soil & Water
Conservation District
73312 Rt. 21
Lyons, NY 14489



Bergmann Associates, Architects, Engineers,
Landscape Architects & Surveyors, D.P.C.

280 East Broad Street
Suite 200
Rochester, NY 14604

office: 585.232.5135
fax: 585.232.4652

www.bergmannpc.com

DATE	DESCRIPTION
------	-------------



Not For
Construction

Copyright © Bergmann Associates, Architects, Engineers,
Landscape Architects & Surveyors, D.P.C

Note:
Unauthorized alteration or addition to this drawing is a violation of
the New York State Education Law Article 145, Section 7209.

Project Manager: T. KETCH	Checked By: T. KETCH / J. REPP
Designed By: C. O'CONNELL	Drawn By: T. BURKE / B. GEORGE
Date Plotted: 9/7/2021	Plot Number: 014801.00

COVER SHEET

Draft - 65%

C000

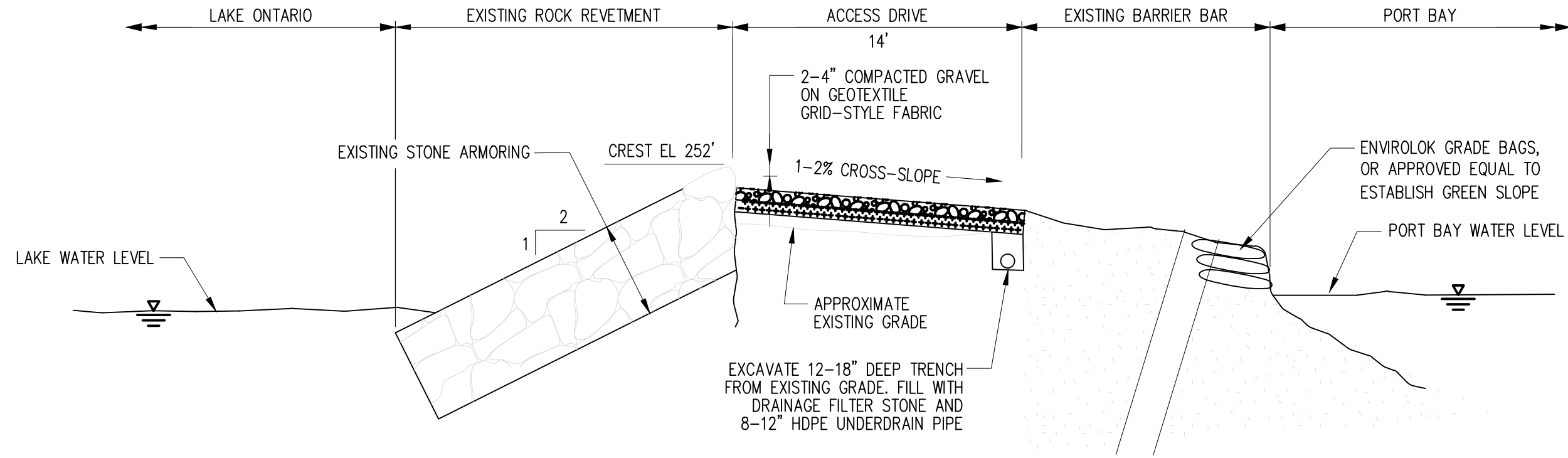

2 ROADWAY SECTION, STA 0+00 TO 9+00
SCALE: NOT TO SCALE



3 GRAVEL DRIVE, GENERAL DESIGN INTENT
SCALE: NOT TO SCALE

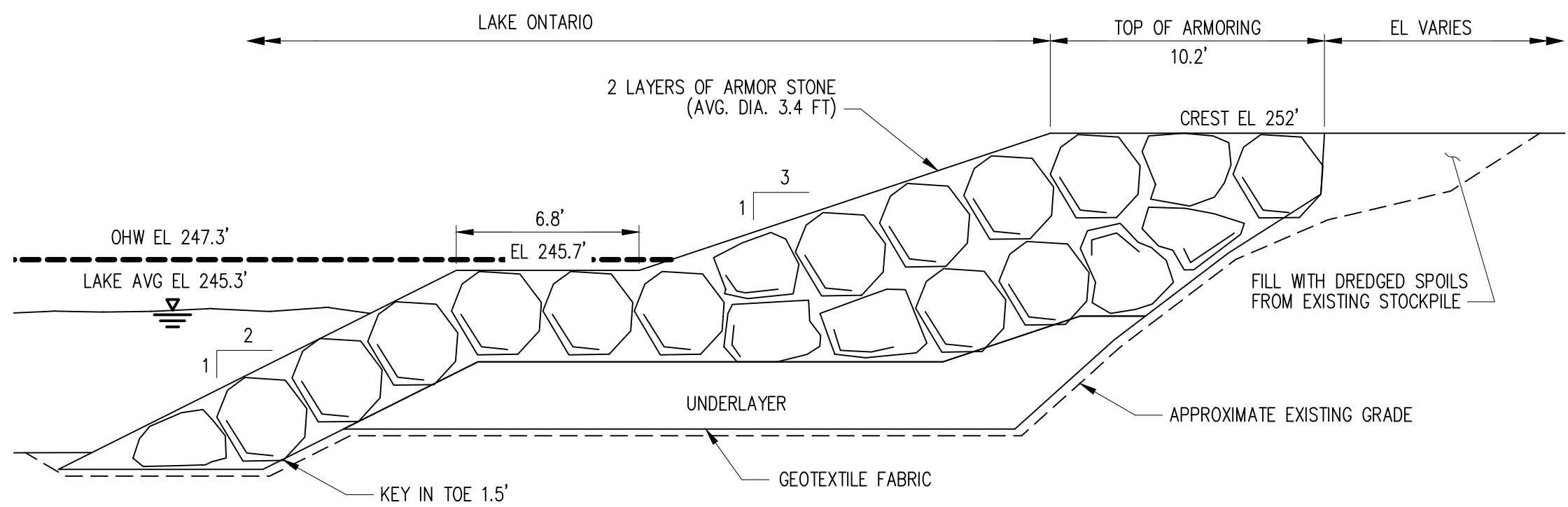

4 STONE ARMORING AND FILL SECTION
SCALE: NOT TO SCALE

NOTE:
ARMOR STONE 2T - 4.5T
UNDERLAYER: 270 LB - 900 LB

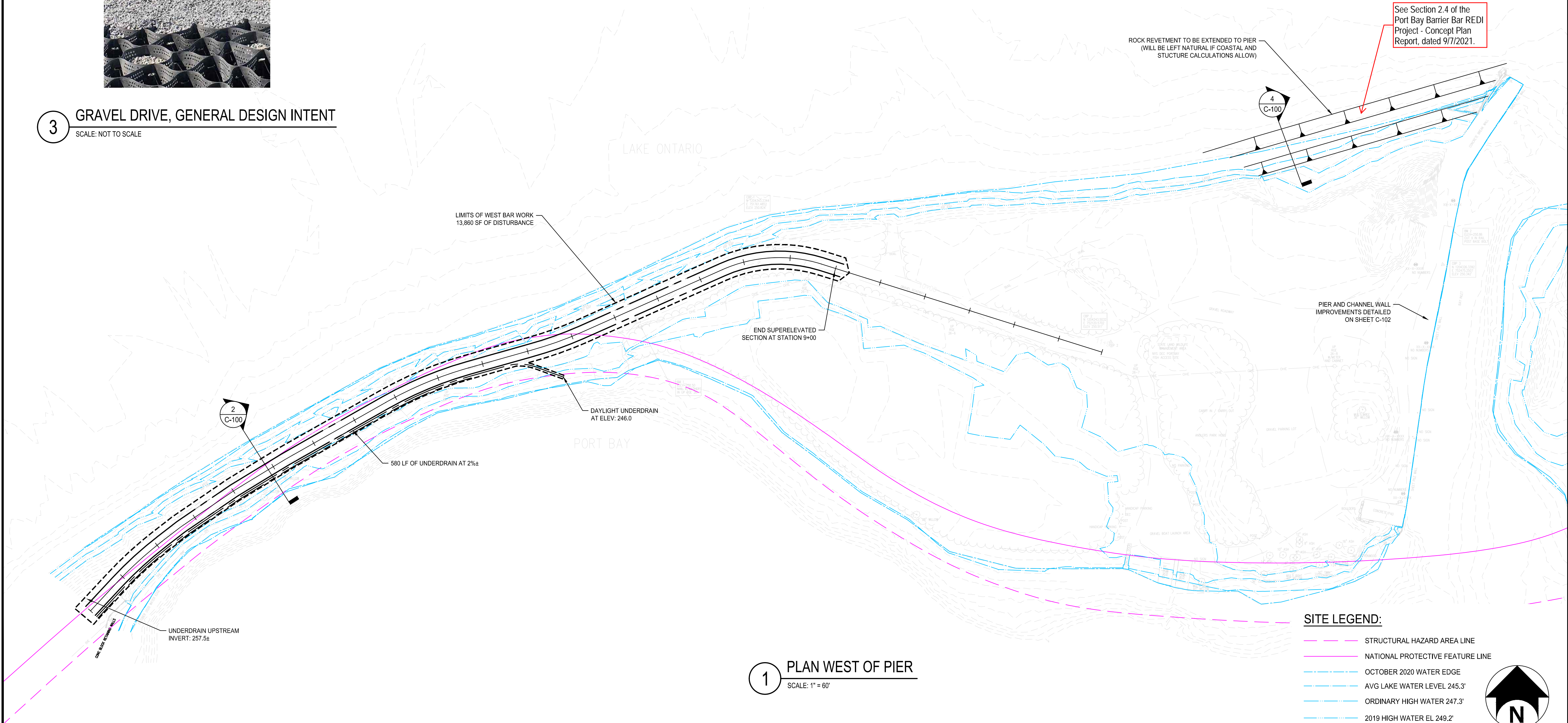

1 PLAN WEST OF PIER
SCALE: 1" = 60'

SITE LEGEND:

- STRUCTURAL HAZARD AREA LINE
- NATIONAL PROTECTIVE FEATURE LINE
- OCTOBER 2020 WATER EDGE
- AVG LAKE WATER LEVEL 245.3'
- ORDINARY HIGH WATER 247.3'
- 2019 HIGH WATER EL 249.2'

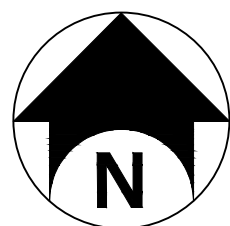

PORT BAY BARRIER BAR

SHORELINE REHABILITATION
AND PIER REPLACEMENT



Wayne County Soil & Water
Conservation District
73312 Rt. 21
Lyons, NY 14489



Bergmann Associates, Architects, Engineers,
Landscape Architects & Surveyors, D.P.C.
280 East Broad Street
Suite 200
Rochester, NY 14604

office: 585.232.5135
fax: 585.232.4652

www.bergmannpc.com

DATE	DESCRIPTION
------	-------------

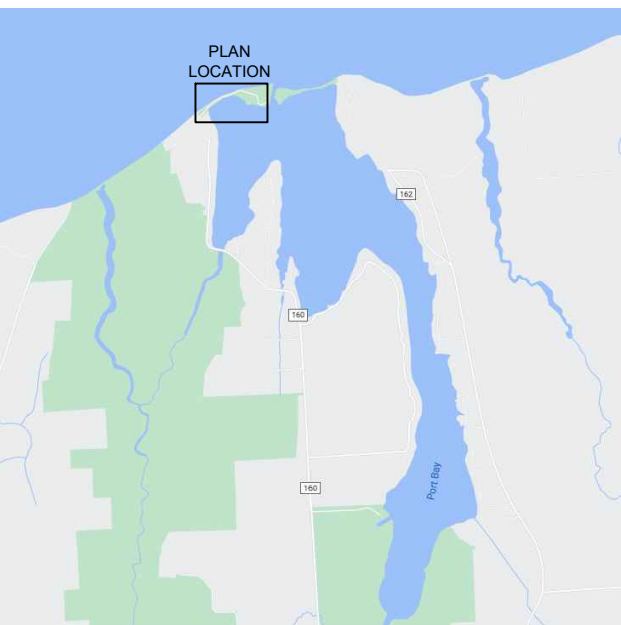

Not For
Construction

Copyright © Bergmann Associates, Architects, Engineers,
Landscape Architects & Surveyors, D.P.C.

Note:
Unauthorized alteration or addition to this drawing is a violation of
the New York State Education Law Article 145, Section 7209.

Project Manager: T. KETCH	Checked By: T. KETCH / J. REPP
Designed By: C. O'CONNELL	Drawn By: T. BURKE / B. GEORGE
Date: 9/7/2021	Project Number: 014801.00

WEST BAR
CONSTRUCTION

Draft - 65%

Drawing Number:

C100

PORT BAY BARRIER BAR

SHORELINE REHABILITATION AND PIER REPLACEMENT



Wayne County Soil & Water
Conservation District
73312 Rt. 21
Lyons, NY 14489



Bergmann Associates, Architects, Engineers,
Landscape Architects & Surveyors, D.P.C.
280 East Broad Street
Suite 200
Rochester, NY 14604

office: 585.232.5135
fax: 585.232.4652

www.bergmannpc.com

DATE	DESCRIPTION
------	-------------



Not For Construction

Copyright © Bergmann Associates, Architects, Engineers,
Landscape Architects & Surveyors, D.P.C

Note:
Unauthorized alteration or addition to this drawing is a violation of
the New York State Education Law Article 145, Section 7209.

Project Manager: T. KETCH	Checked By: T. KETCH / J. REPP
Designed By: C. O'CONNELL	Drawn By: T. BURKE / B. GEORGE
Date Issued: 9/7/2021	Project Number: 014801.00

EAST BAR CONSTRUCTION

Draft - 65%

C101

3 of 4

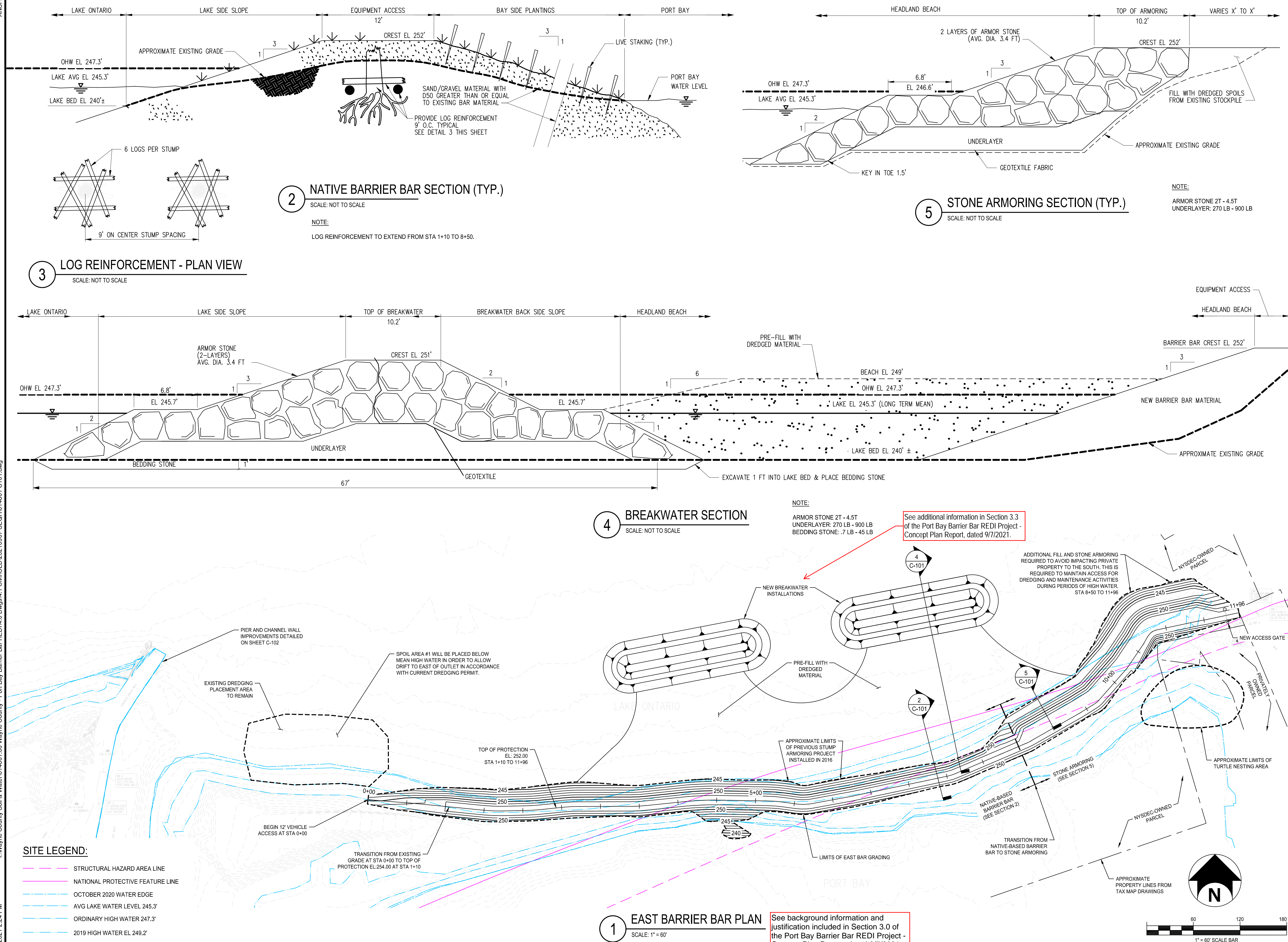

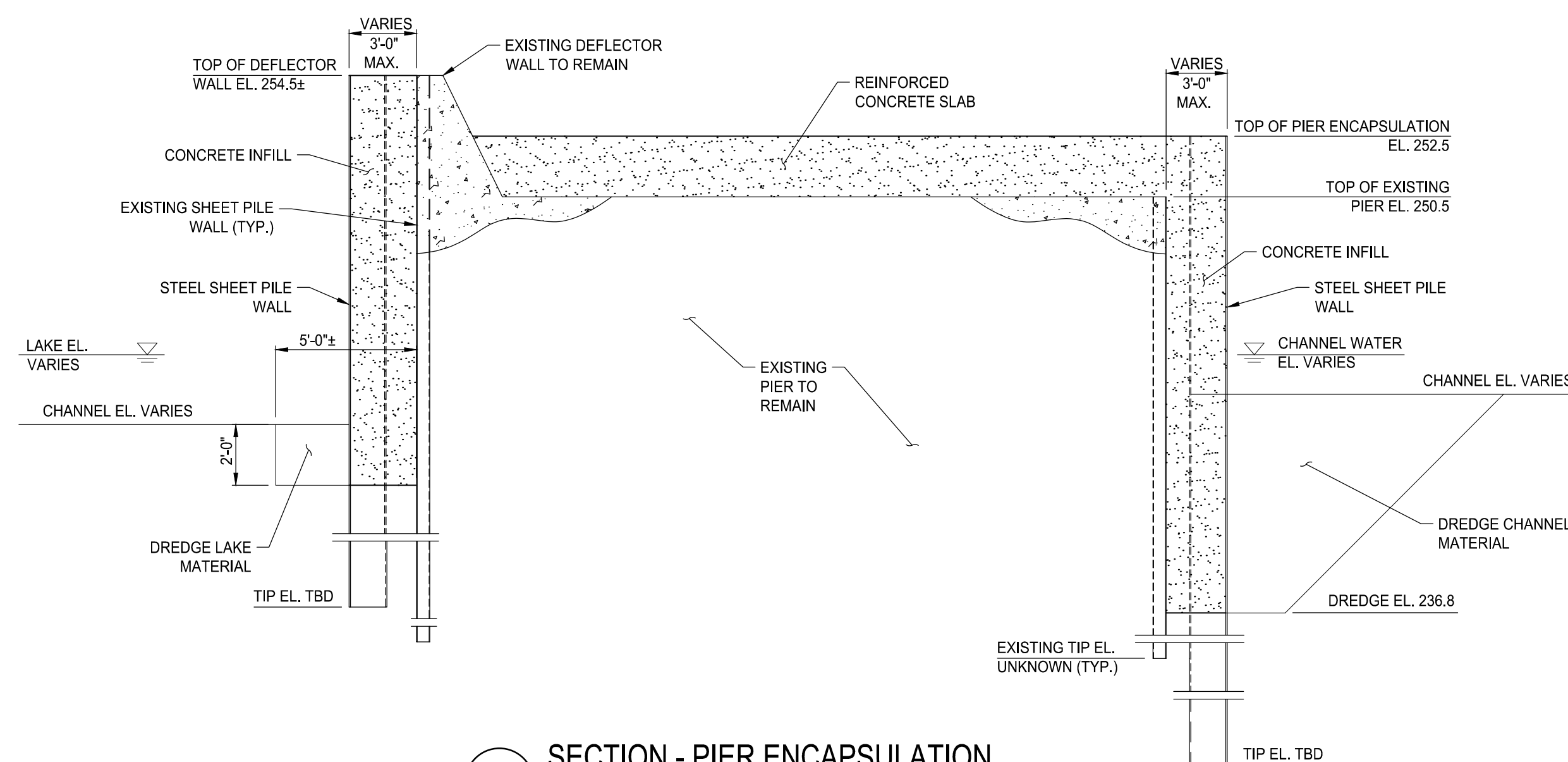
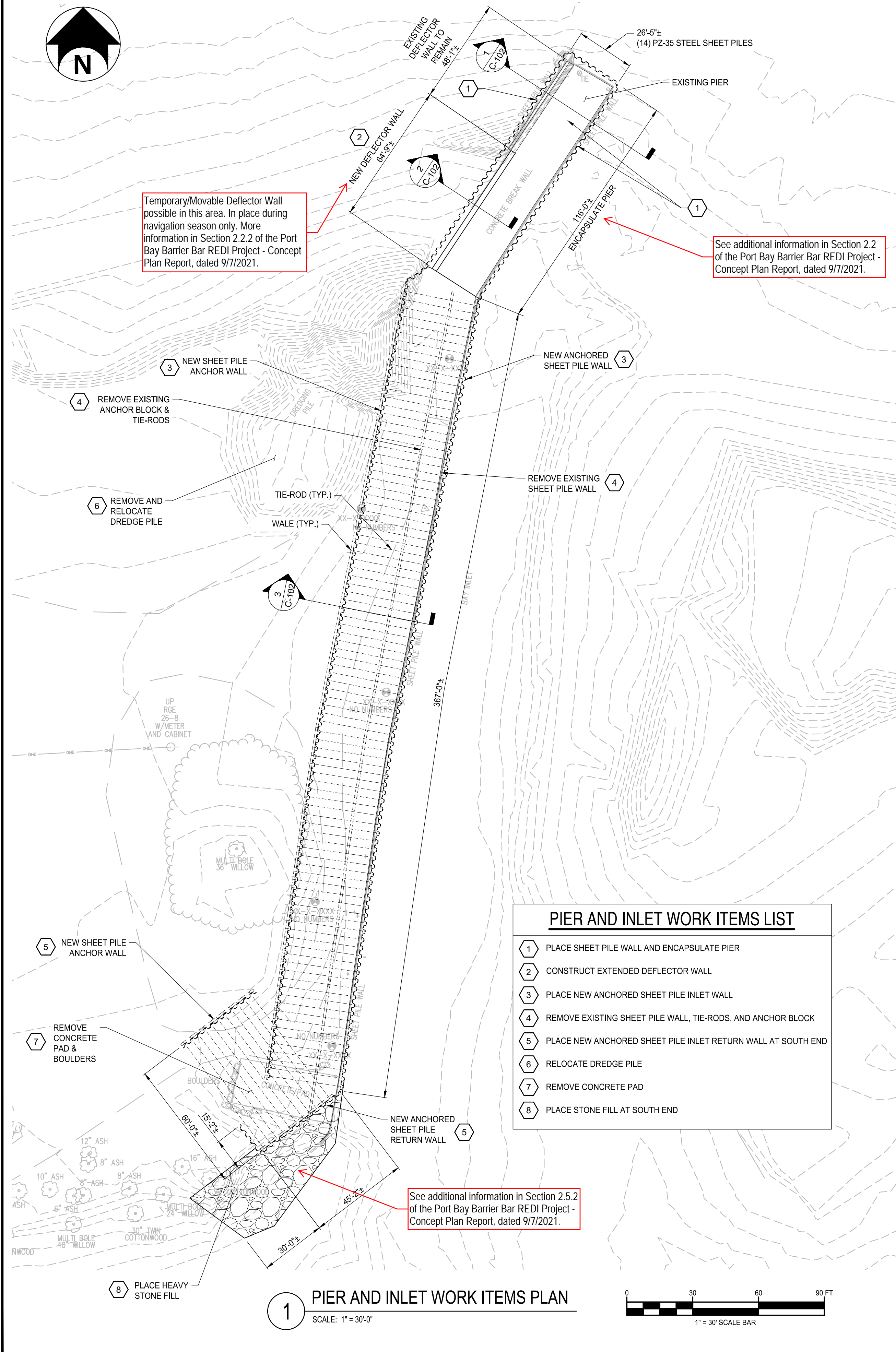
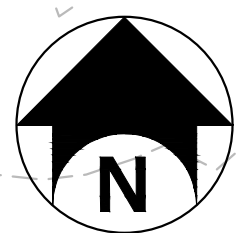

SECTION - PIER ENCAPSULATION

SCALE: $\frac{1}{4}" = 1'-0"$
NOTE: REINFORCEMENT NOT SHOWN

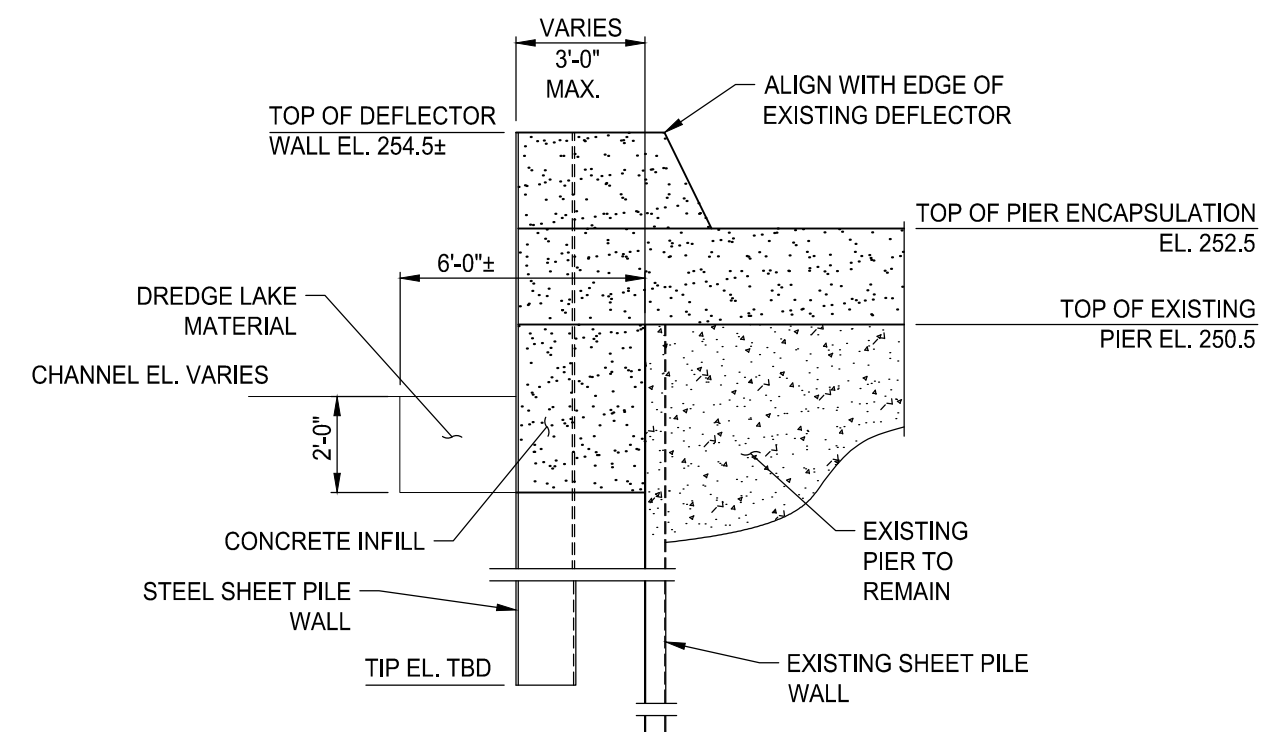

SECTION - NEW DEFLECTOR WALL

SCALE: $\frac{1}{4}" = 1'-0"$
NOTE: REINFORCEMENT NOT SHOWN

PIER AND INLET WORK ITEMS LIST

1	PLACE SHEET PILE WALL AND ENCAPSULATE PIER
2	CONSTRUCT EXTENDED DEFLECTOR WALL
3	PLACE NEW ANCHORED SHEET PILE INLET WALL
4	REMOVE EXISTING SHEET PILE WALL, TIE-RODS, AND ANCHOR BLOCK
5	PLACE NEW ANCHORED SHEET PILE INLET RETURN WALL AT SOUTH END
6	RELOCATE DREDGE PILE
7	REMOVE CONCRETE PAD
8	PLACE STONE FILL AT SOUTH END

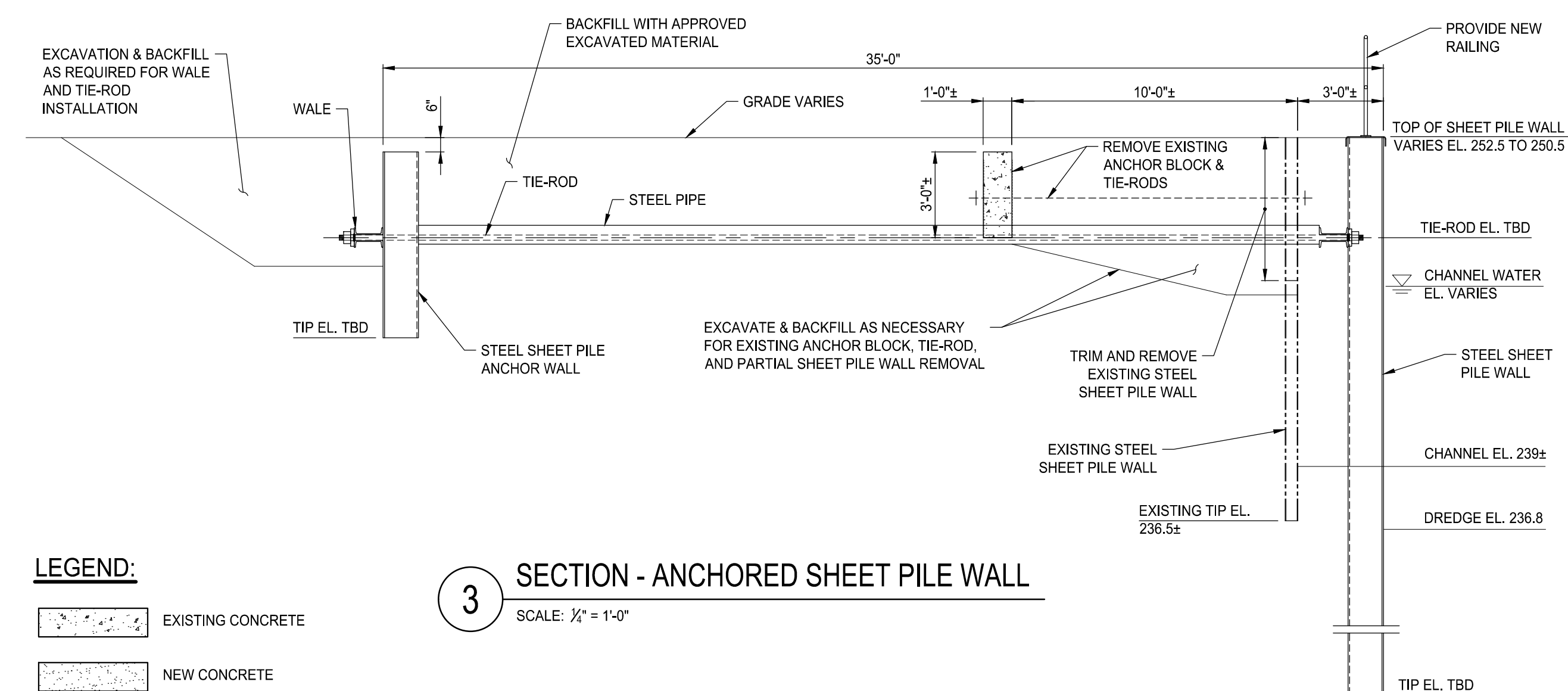

SECTION - ANCHORED SHEET PILE WALL

SCALE: $\frac{1}{4}" = 1'-0"$

LEGEND:

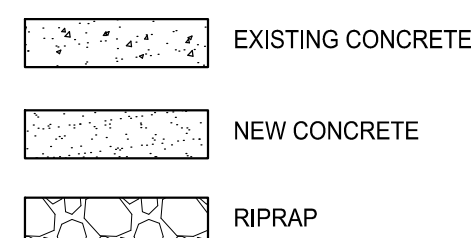

PORT BAY BARRIER BAR

SHORELINE REHABILITATION AND PIER REPLACEMENT



Wayne County Soil & Water
Conservation District
73312 Rt. 21
Lyons, NY 14489



Bergmann Associates, Architects, Engineers,
Landscape Architects & Surveyors, D.P.C.
280 East Broad Street
Suite 200
Rochester, NY 14604

office: 585.232.5135
fax: 585.232.4652

www.bergmannnpc.com

DATE	DESCRIPTION
------	-------------



Not For Construction

Copyright © Bergmann Associates, Architects, Engineers,
Landscape Architects & Surveyors, D.P.C.

Note:
Unauthorized alteration or addition to this drawing is a violation of
the New York State Education Law Article 145, Section 7209.

Project Manager: T. KETCH	Checked By: T. KETCH / J. REPP
Designed By: D. GUETTA	Drawn By: S. SULTANA
Date Issued: 9/7/2021	Project Number: 014801.00

PIER AND INLET CONSTRUCTION

Draft - 65%

Drawing Number

C102